

Slim-T system

Open-cell ceiling based on T15 / T24 construction.

- made from oven-paint coated aluminium
- universal - meant for use with standard ceiling suspension construction
- very high degree of light-, fumes- and fire installation penetration
- rigid and aesthetic, easy to keep clean
- easily accessible overhead installations
- possible to install lighting fixtures
- quick and easy installation
- possible to incorporate with different types of mineral ceilings as well as in connection with different types of infills
- in any panel dimensions and any cell size
- optionally with perforated elements to use with acoustic elements
- wide range of colours

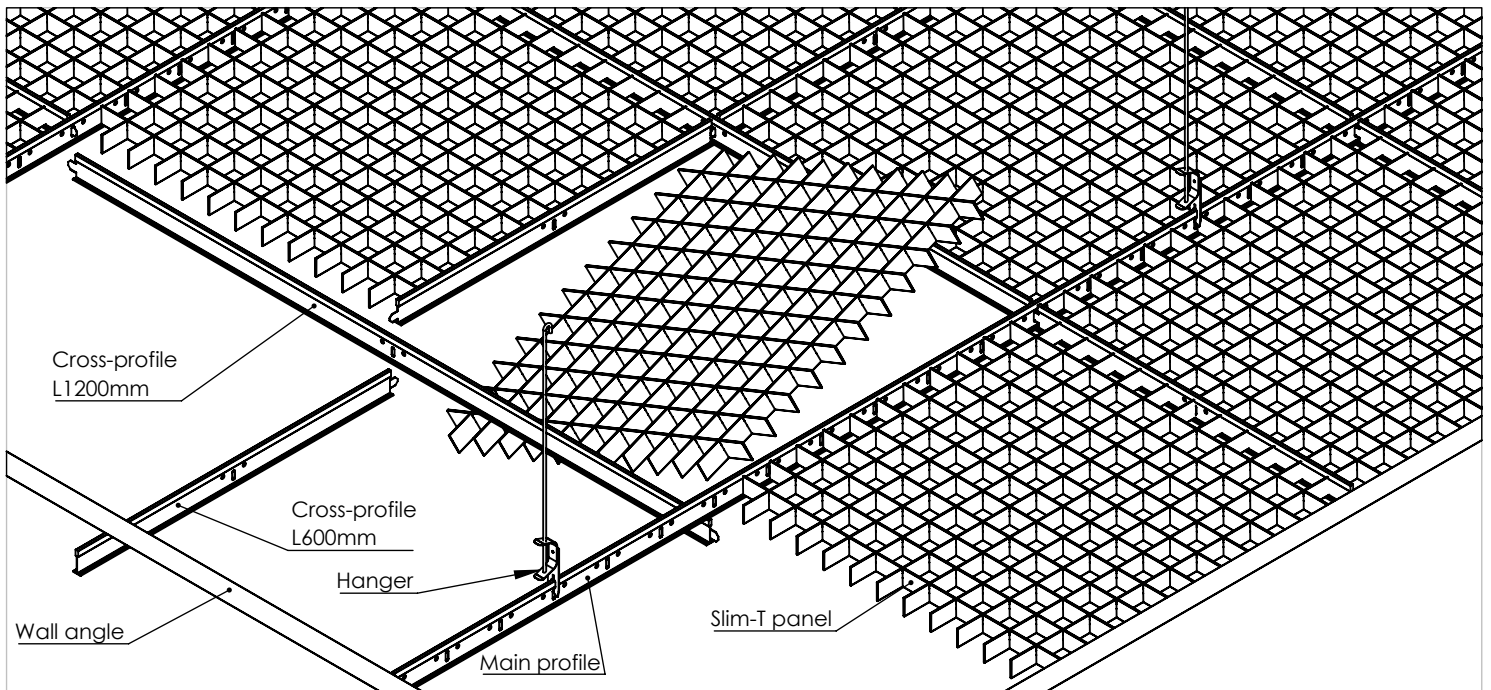

Main profiles

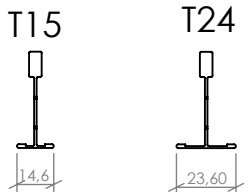

Standard panel dimensions

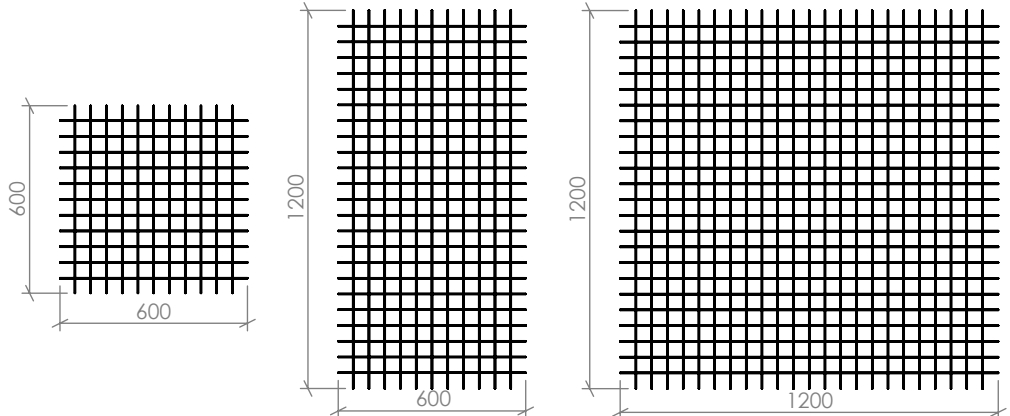

Elements profiles

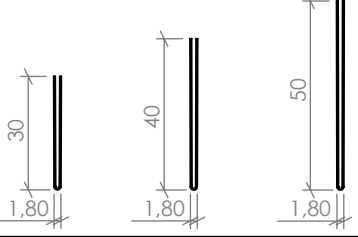

Finish standards

Lay-on - Type-A edge

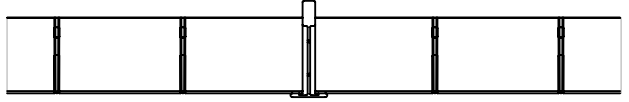
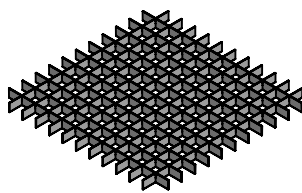

Wall angles

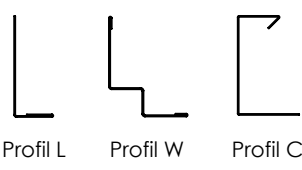

Lay-on - Type-E edge

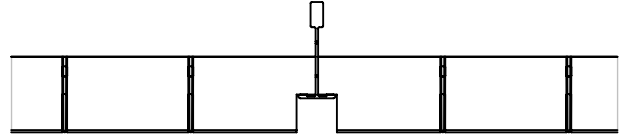
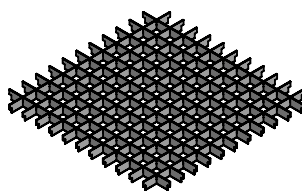

Light fixture plates

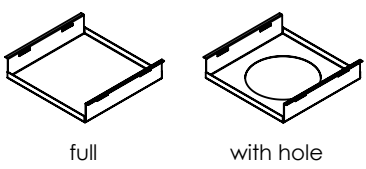

Ceiling parameters

Cell size	Profil T15 Open area %	Profil T24 Open area %	Viewing angle		
			H30	H40	H50
50x50	88,6	85,8	32°	39°	46°
75x75	90,9	88,1	22°	28°	37°
100x100	92,1	89,2	17°	22°	24°
120x120	92,7	89,8	13°	18°	22°
150x150	93,3	90,4	10°	14°	18°
200x200	93,8	91	8°	10°	13°
300x300	94,4	91,5	5°	7°	9°



Jacentów 61A
27-580 Sadowie
Tel: +48 15 868 21 28
+48 15 869 26 88
info@pwkrzystof.com.pl

There's a possibility of non-standard versions and different accessories. In case of questions please contact us.